

Survey Data

Marco Corvi

marco.corvi@gmail.com

2017

TopoDroid survey data

- downloaded from DistoX
- entered manually

DistoX data

- **Download modes**
 - on demand download
 - continuous download (option: auto-reconnect)
 - multi-DistoX
- N.B. if Android continuously asks the PIN, use the insecure socket

Stations

- **Station names** are arbitrary (but no spaces)
 - 0, 1, 2, ... 2a, 2b, ... 3A, 3B, ... a1, a2, ...
- **Station** automatic assignment. Six policies
 - default: splays + forward leg

Good because sequence of close leg shots at the end
- **Active station** (green)
 - selectable
 - from saved stations

Check downloaded data

- DistoX may fail (both distance and angles)
- TopoDroid may fail to assign stations
- Always check downloaded data
 - check values on the DistoX display
 - check values in TopoDroid data list
 - check shot in TopoDroid sketches

Manual data

- **FROM** and **TO** stations
- **distance, azimuth, clino** (all in the current units)
- extend
- flags
- comment
- LRUD
- optional backvalues

- manual shot values are editable (length, azimuth, clino)
- data values can have a **calibration** (offset to subtract)

Howto's

- recover a skipped leg
- change station to a group of splays
- delete or restore a shot
- display the splays at a station
- Set active station
- add a photo or a sensor measurement

Recover a skipped leg

- edit the first shot of the leg
- set the FROM and TO station
- check the button “renumber”
- save
- you might have to edit the additional leg shots and specify they go with the previous leg

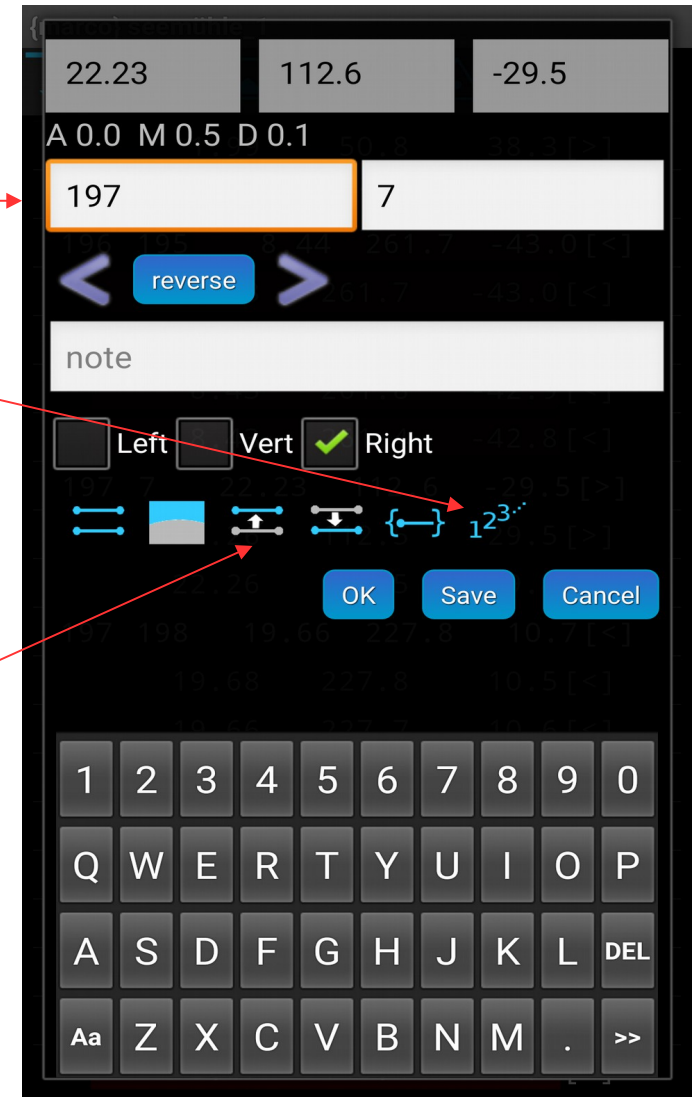

Change station to a group of splays

- a group of splays consists of all the splays between two consecutive legs
- edit a splay of the group
- change the FROM station
- select the “group” button
- save

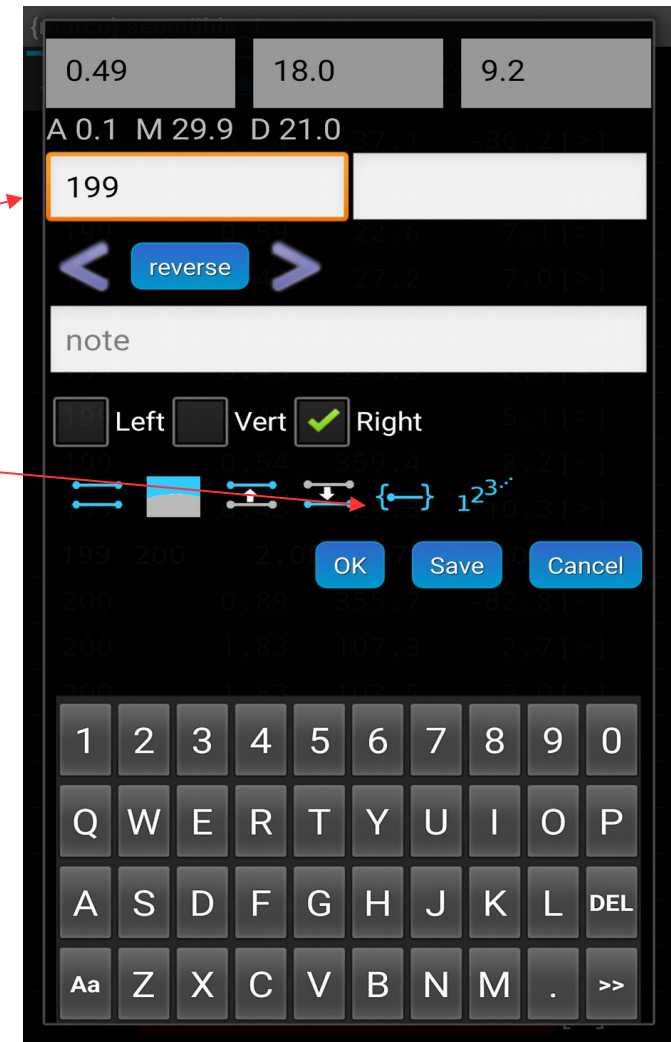

Delete or restore a shot

edit the shot by tapping the clino

select the delete button

to restore a deleted shot go to the
survey-info window

select the “recover” menu

select the shot to restore

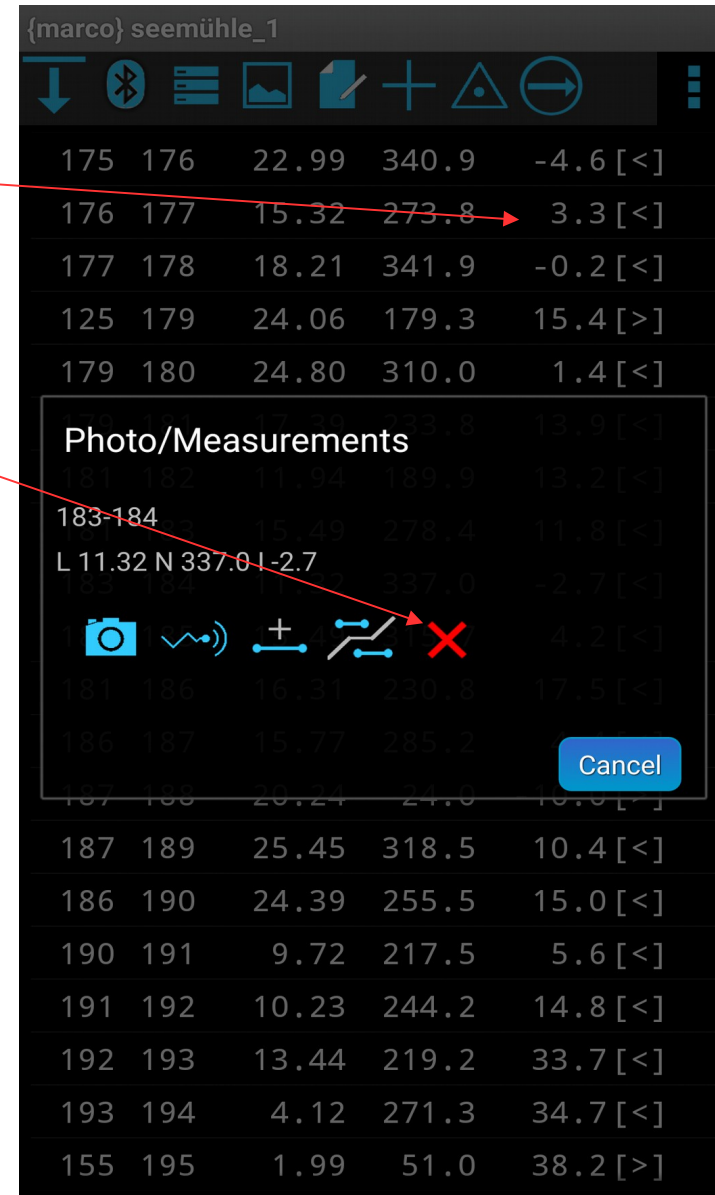

Display the splays at a station

- to show or hide the splays at a specific station,
short tap on the station name
- NB hiding works also by tapping the station in a splay shot

Set the active station

- long tap the station name
NB. works also on the station name in splays
- select the station in the saved stations dialog
and tap the “active” button

Photo and sensor measurements

- tap on the clino value of the shot entry
- select the “photo” button or the “sensor” button
- the list photos and sensor measurements are displayed
 - by the “photo” and “sensors” menus of the data window
 - by the “photo” and “sensors” buttons of the survey window

{marco} seemühle_1

175	176	22.99	340.9	-4.6 [<]
176	177	15.32	273.8	3.3 [<]
177	178	18.21	341.9	-0.2 [<]
125	179	24.06	179.3	15.4 [>]
179	180	24.80	310.0	1.4 [<]

Photo/Measurements

183-184
L 11.32 N 337.0 I -2.7

Photo/Measurements dialog buttons: Camera, Sensor, Add, Edit, Delete

Cancel

181	186	16.21	230.8	17.5 [<]
186	187	15.77	285.2	4.2 [<]
187	188	20.24	247.0	10.0 [>]
187	189	25.45	318.5	10.4 [<]
186	190	24.39	255.5	15.0 [<]
190	191	9.72	217.5	5.6 [<]
191	192	10.23	244.2	14.8 [<]
192	193	13.44	219.2	33.7 [<]
193	194	4.12	271.3	34.7 [<]
155	195	1.99	51.0	38.2 [>]